

MGS roller blinds

knall
quality & style

Description: Thanks to an integrated collar that covers the drive, the blind does not collect dust, and it visually resembles a cassette blind. Additionally, the collar provides side lead of the material. A possibility to apply a connector of a bearing rail allows to combine even several blinds with minimal distances between the neighboring pieces of fabric.

Mounting location: Inside and outside window recess

Mounting: screwed

Handling: a self-braking chain mechanism enabling to stop the blind in a any given position

Tube: Aluminum tube Ø24-28

Maximum dimensions: 300x300 cm

Cassette color: White, Brown, Gray Ral 7043



Construction of the mechanism

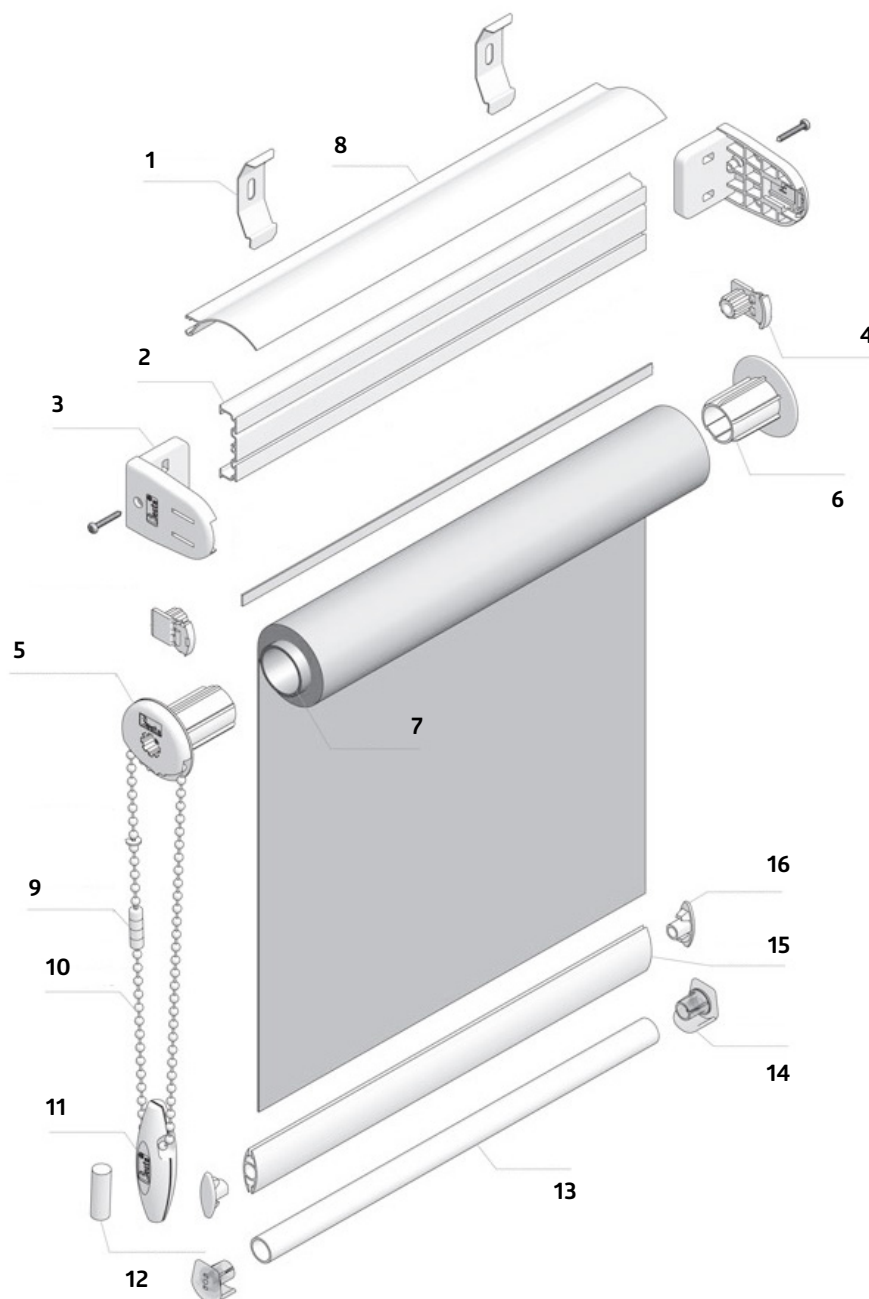

- 1 - Clip
- 2 - Bracket profile
- 3 - Handle MGS
- 4 - Insert bearing
- 5 - Mechanism MGS (Ø24 lub Ø28)
- 6 - Plug MGS (Ø24 lub Ø28)
- 7 - Steel tube Ø24 or aluminum tube Ø28
- 8 - Cover profile MGS
- 9 - Chain connector
- 10 - Chain T-60
- 11 - Chain weight
- 12 - Weight
- 13 - Aluminum tube Ø12
- 14 - The tube cover
- 15 - Steel bar
- 16 - Steel bar cover

Dimensions of the elements

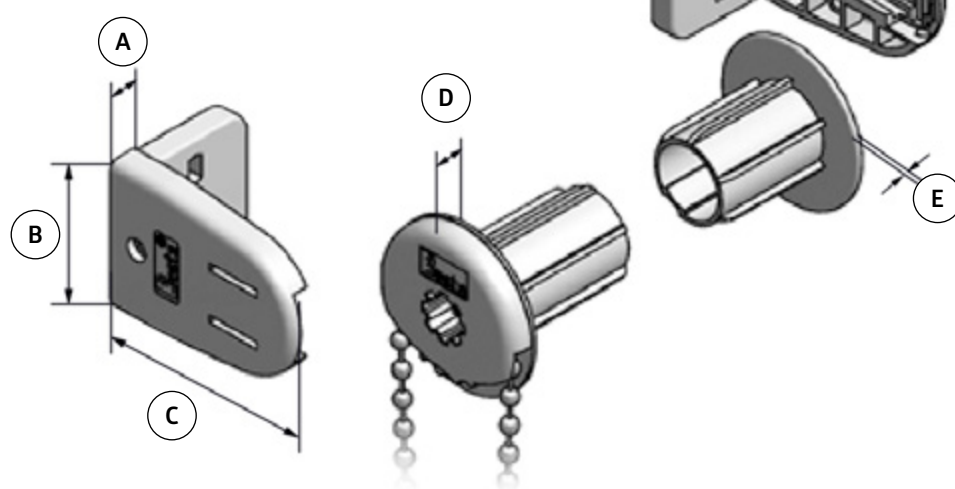

A - 8 mm - WIDTH OF THE HOLDER MGS
B - 44 mm - HIGH OF THE HOLDER MGS
C - 60 mm - LENGTH OF THE HOLDER MGS

D - ok 8 mm - MECHANISM COLLAR
E - ok 1 mm - PLUG COLLAR

MGS connector (Joint)

Connector of a bearing rail allows to combine even several blinds with minimal distances.

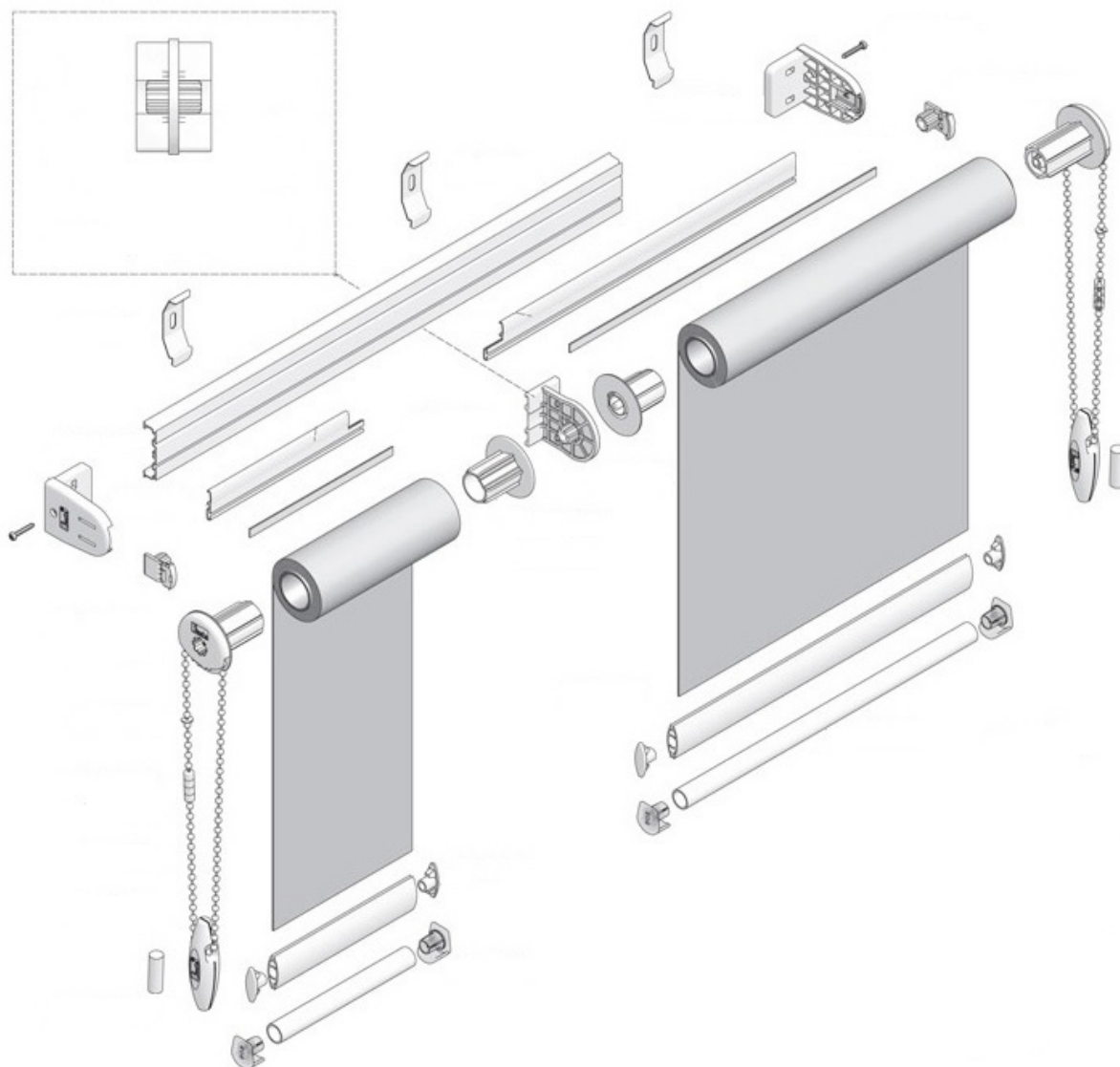

The width of the roller shutter mechanism is always greater than the width of the fabric about 34mm (17mm from every side). The combination of blinds with a switch rail reduces the distance between the fabrics to 10 mm (5 mm on each side)

Roller Blinds measuring instructions

Long and failure-free operation of a window shutter depends not only its high quality but also on correct fit and installation. To make the cover fit perfectly, the chosen place needs to be correctly and carefully measured.

You need to strictly follow the below supportive drawing:

Fitting inside window recess

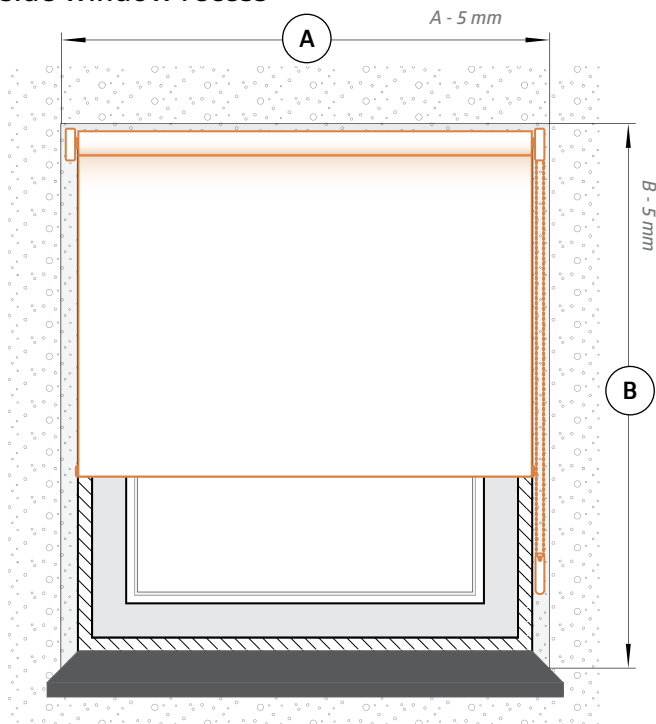

A - WIDTH OF THE RECESS

If the recess width is not the same in all spots, the lowest dimension of the recess should be assumed. 5mm is the distance that needs to be subtracted from the window recess width in order to install the vertical blind freely.

B - HIGH OF THE RECESS

If the recess height is not the same in all spots, the lowest dimension of the recess should be assumed. 5mm is the distance that needs to be subtracted from the window recess height in order to install the vertical blind freely

** The upper blind mechanism will cover about 8 cm in high from window recess.*

Fitting outside window recess

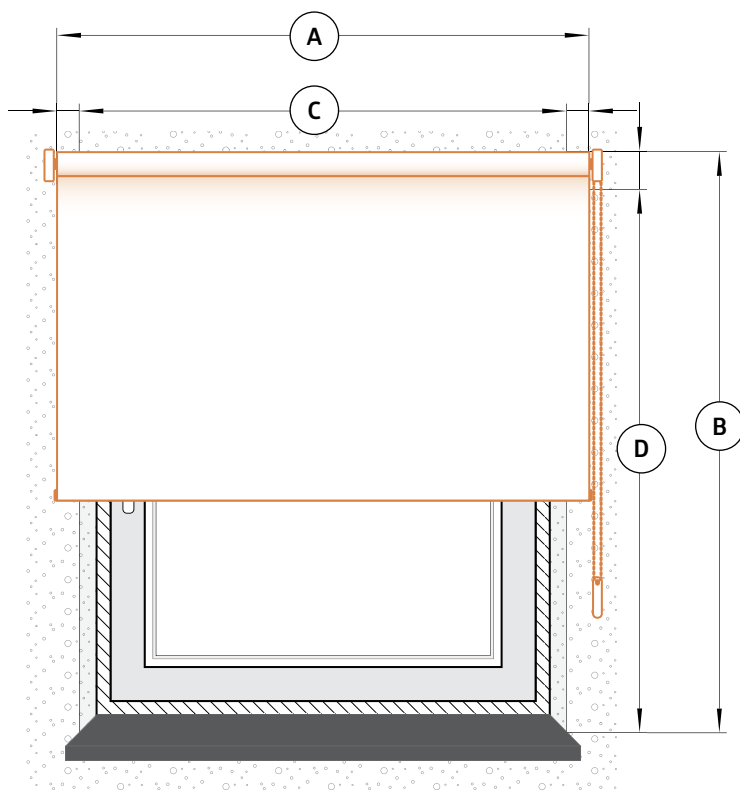

A - WIDTH OF THE FABRIC

B - HIGH OF THE BLINDS

C - WIDTH OF THE RECESS

D - HIGH OF THE RECESS

Use this option if you want install the blind outside window recess. We suggest that the blinds is 8-10 cm wider each side than window recess. Also add 8-10 cm above and below window to be sure that the blind will cover the window.

** The upper blind mechanism is 8 cm height and its contained in height size of the blind*

** All dimensions must be entered in millimeters*